

SG-S171

› Intel® Celeron® J3455 / Atom™ x7-E3950 Processor
Fanless and All-around IP66 / IP69K Stainless
17" Panel PC



Features



- Intel® Celeron® J3455 / Atom™ x7-E3950 processor on board
- Fanless and quiet design
- Stainless steel SUS304 / SUS316
- All-around IP66 / IP69K mechanical design
- M12 waterproof connectors
- Supports 5-wire resistive touchscreen or projected capacitive touchscreen

Specifications



System

CPU Type	Intel® Celeron® J3455 processor Intel® Atom™ x7-E3950 processor
Chipset	Intel® SoC
Memory Support	1 x DDR3L 1600/1867MHz SO-DIMM socket (up to 8G) (non-ECC)
Enclosure	Stainless SUS304/SUS316
IP Rating	IP66/IP69K
Power Input	DC In 12V/16~24V
Watchdog	1~255 second watchdog timer selectable
Operating System	Windows 10 IoT LTSC 2019 / Ubuntu 16.04
Dimensions	450 x 381 x 70 mm (W x H x D)
System Weight	11.5 kg
Mounting Support	Wall mount / VESA 100 / Stand / Table
Certifications	FCC / CE

Display

LCD	17" TFT LCD (LED) resolution 1280 x 1024
Touchscreen	5-wire resistive touchscreen or projected capacitive touchscreen (USB interface)

Applications

- Automation
- Food Service
- Information

I/O Ports

Power Input	1 x M12 waterproof connector, supporting 12V/16~24V DC
USB	4 x USB 2.0 from two M12 waterproof connectors
Serial Port	1 x COM port with M12 waterproof connector COM 1 for RS-232/422/485
LAN	2 x GbE LANs with M12 waterproof connector LAN 1: Intel® I210IT LAN 2: Intel® I210IT Supports Wake-On-LAN
Storage	1 x 2.5" SATA III HDD or SSD
Expansion Slot	1 x full-sized Mini PCIe slot (Mini PCIe and USB signal)

Environment

Operating Temp.	HDD: 0°C~40°C (32°F~104°F) (Ambient with airflow) SSD: 0°C~50°C (32°F~122°F) SSD: Wide-ranged temperature: -20°C~50°C (-4°F~122°F) (x7-E3950 only)
Storage Temp.	-20°C~80°C (-4°F~176°F)
Humidity	20%~90%

Highlights

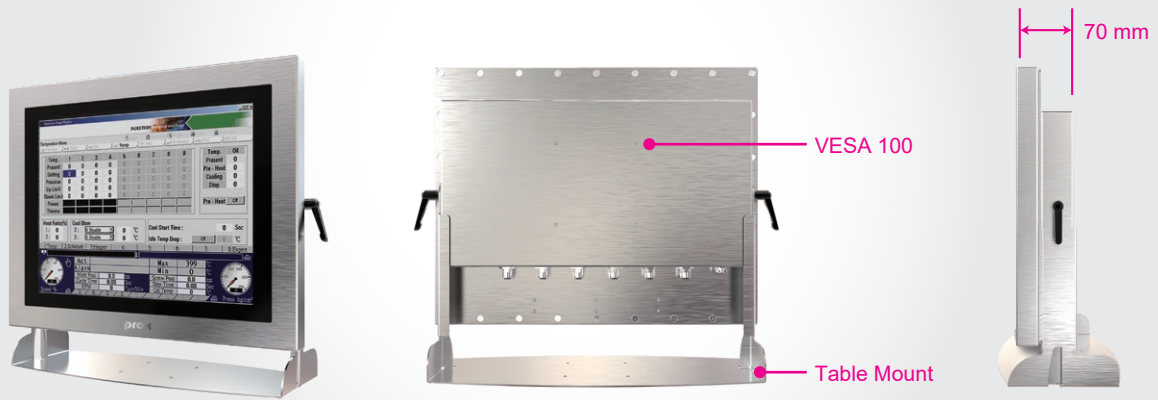

I/O Panel View

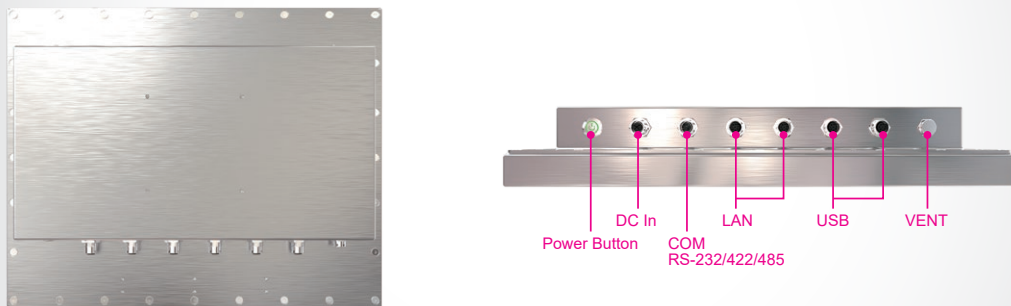

Dimensions

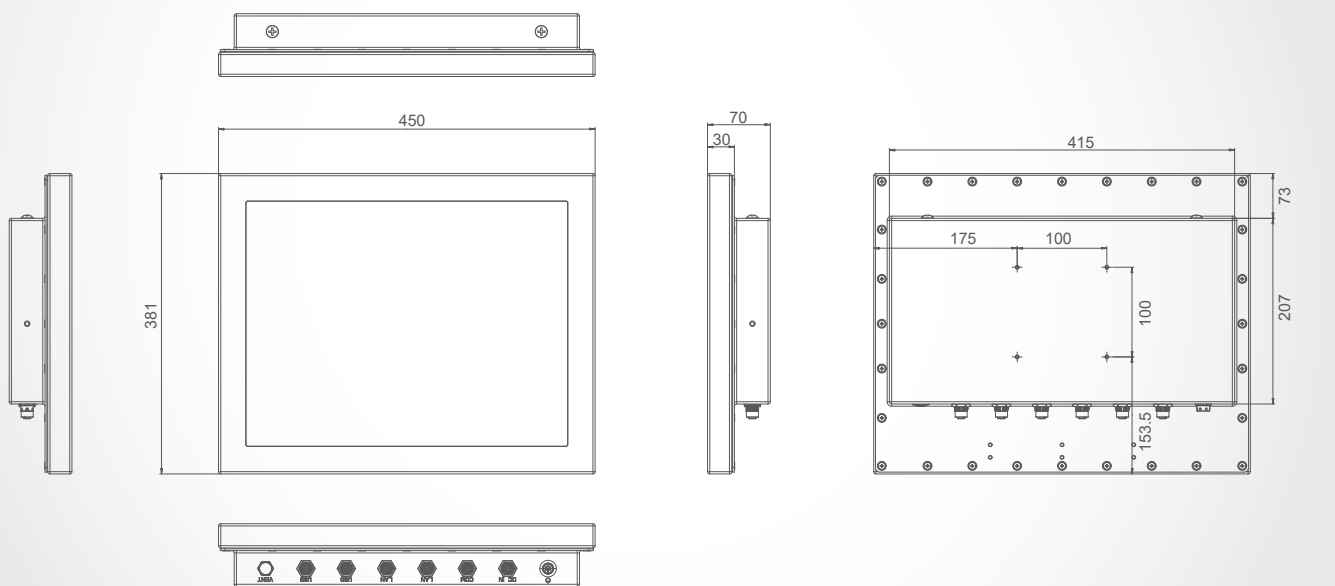

unit: mm